

BD MAX™ CT/GC/TV endocervical specimen collection and transfer procedure

BD MAX™ UVE Specimen Collection Kit

Clinician collection procedure

- 1. Precaution:** Do **not** collect specimen at the posterior fornix
- Lukewarm water may be used to warm and lubricate the speculum.
- If lubricant must be used, lubricant should be used sparingly (1.8 mm) and applied only to the exterior sides of the speculum blades, avoiding contact with the tip of the speculum.
- Holding the swab by the white cap, insert the swab into the cervical canal and rotate for 15 to 30 seconds.

How to use lubricant for the collection of endocervical swabs

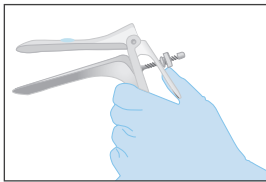

Apply a 1.8 mm amount of lubricant on the speculum

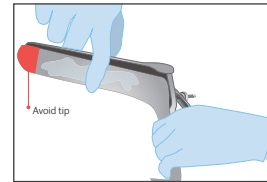
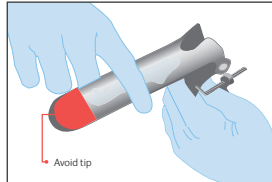

Apply only to exterior sides of the speculum, avoiding the tip.*
*Avoid use of lubricants that contain carbomer (or carbopol polymers).

Avoid contact between the swab and the speculum or lubricant.

Swab to tube transfer procedure (clinician collected and patient self-collected)

To transfer the sample

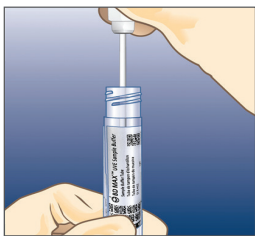

1. Fully insert the swab into the tube so that the tip is at the bottom.

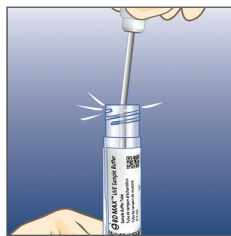

2. Carefully break the shaft at the score mark. Be careful to avoid splashing.

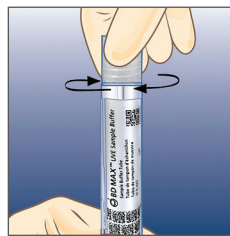

3. Tightly re-cap the tube.

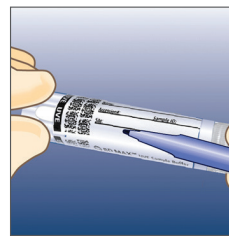

4. Label tube with patient information, date, and time collected. Be careful not to obscure the bar codes on the tube.

Swab Storage and Transport

Swab sample must be transferred within 2 hours after collection to the BD MAX™ UVE Sample Buffer Tube when kept at 2°C to 30°C.

Specimen Type:

Vaginal/Endocervical swab collection for BD MAX CT/GC/TV (requiring pre-warm)

In BD MAX UVE Sample Buffer Tube prior to testing

2–30°C	-20°C
5 days	30 days

BD, Sparks, MD 21152-0999 USA
800.638.8663

bd.com

